

Parties

HER MAJESTY THE QUEEN
in right of New Zealand

and

WAIKATO

DEED TO AMEND
DEED OF SETTLEMENT

November 1996

Deed of Settlement: Amendment No. 2

THIS DEED is made on the day of November 1996

BETWEEN

- (1) **HER MAJESTY THE QUEEN** in right of New Zealand acting by the Prime Minister
- (2) **WAIKATO**

BACKGROUND

- A. The Crown and Waikato are parties to a Deed of Settlement dated 22 May 1995 (which in its form amended by a Deed to Amend in November 1995 is referred to below as the "Deed of Settlement").
- B. The Crown and Waikato wish to amend the Deed of Settlement in the manner described in Clause 30 of the Deed of Settlement.

ACCORDINGLY, the Crown and Waikato agree as follows:

1 DEFINITIONS AND INTERPRETATION

Except as otherwise provided in this Deed or unless the context otherwise requires, terms defined in the Deed of Settlement have the same meaning in this Deed and the rules of interpretation set out in the Deed of Settlement will apply in the interpretation of this Deed.

2 AMENDMENTS TO ATTACHMENT 2 AND ATTACHMENT 3

The Deed of Settlement is amended by:

- 2.1 replacing those descriptions of Settlement Properties in Attachments 2 and 3 where the Agency referred to in Column 4 is "CoalCorp" or "Crown-CoalCorp" with the details set out in *Appendix 1* to this Deed; and
- 2.2 replacing those descriptions of Settlement Properties in Attachments 2 and 3 where the Agency referred to in Column 4 is "RailCorp" with the details set out in *Appendix 2* to this Deed.

3 **AMENDMENT TO CLAUSE 8**

- 3.1 Subject to Clause 3.2 below, Clause 8.2 of the Deed of Settlement has effect, in respect of the Settlement Properties for which the Agency referred to in Column 4 of Attachment 2 and Attachment 3 is "Crown-CoalCorp" or "CoalCorp" (as amended by this Deed), as if the date by which the election to be made under Clause 8 of the Deed of Settlement were 13 December 1996.
- 3.2 Clause 8.2 of the Deed of Settlement applies without amendment to the CoalCorp Land.
- 3.3 Clause 8.2 of the Deed of Settlement has effect, in respect of the Settlement Property described as "CF1" in Column 9 of Attachment 2 (Maramarua Forests) and the Settlement Properties for which the Agency referred to in Column 4 of Attachment 3 is "Land Corp", as if the date by which the election to be made under Clause 8 of the Deed of Settlement were 31 December 1996.

EXECUTED as a deed on 7 November 1996

SIGNED for and on behalf of)
HER MAJESTY THE QUEEN in right)
of New Zealand by)
JAMES BRENDAN BOLGER)
as Prime Minister in the presence of:)

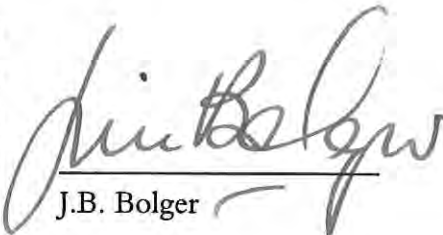
J.B. Bolger

Witness:

Signature: Miriam Evans

Occupation: Policy Adviser

Address: 31 Crofton Rd
Wellington

SIGNED for and on behalf)
of WAIKATO and the Claimants by)
ROBERT TE KOTAHI MAHUTA)
in the presence of:) R.T. Mahuta



Witness:

Craig Beecroft

Signature:

~~C. Beecroft~~

Occupation:

Investment Banking

Address:

62 Scanlan St

PONTOBY

APPENDIX 1

(Reference: Clause 2.1)

Amendments to Attachment 2 and Attachment 3 relating to “CoalCorp” and Crown-CoalCorp” portfolios.

Guide to Appendix 1

In this Appendix, there are references to a part of the land comprised in Certificate of Title 55A/772. The plan referred to in those references follows this page.

CERTIFICATE OF TITLE

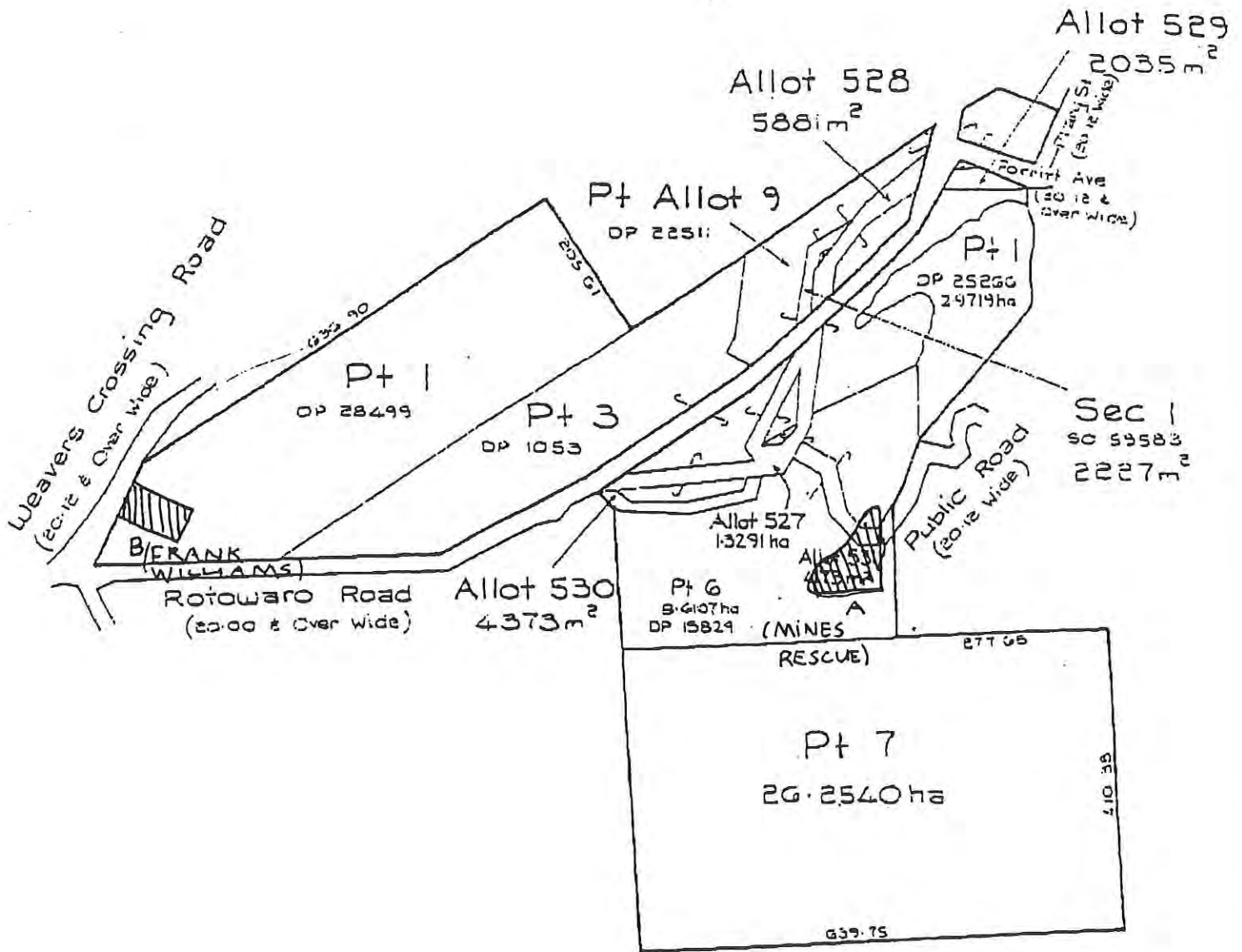

SO 50529, SO 50530, SO 42384, SO 59583

Total Area: 69.9252 ha.

measurements are metric

Attachment 2: Settlement Land

Deed Of Settlement

1 2 3 4 5 6 7 8 9

Property Detail Quarter of Trfr Agency Lease Form Initial Renewal No. Portfolio
Transfer Basis Agency term Term

1281 27A/68 Ohinewai LOT 3 DP 15270 25.0715 4/3 2A CoalCorp CC2
ALLOT 820

Attachment 2: Settlement Land

Deed Of Settlement

| 1 | 2 | 3 | 4 | 5 | 6 | 7 | 8 | 9 |
|-----------------|---------------------|---|--------|------------|--------------|--------------|-----|-----------|
| Property Detail | Quarter of Transfer | Tfr Basis | Agency | Lease Form | Initial term | Renewal Term | No. | Portfolio |
| 1282 43A/451 | OhiNEWAI | PT LOT 2 DP 12979 | 4/3 | 2A | CoalCorp | | CC2 | |
| 1283 33A/443 | OhiNEWAI | ALLOT 761 WHANGAMARINO PSH | 4/3 | 2A | CoalCorp | | CC2 | |
| 1284 33A/52 | OhiNEWAI | ALLOT 571 TAUPIRI PSH | 4/3 | 2A | CoalCorp | | CC2 | |
| 1285 33A/444 | OhiNEWAI | LOT 1 DP 36936 | 4/3 | 2A | CoalCorp | | CC2 | |
| 1286 33B/329 | OhiNEWAI | ALLOT 591 WHANGAMARINO PSH | 4/3 | 2A | CoalCorp | | CC2 | |
| 1287 634/172 | OhiNEWAI | ALLOT 509 WHANGAMARINO PSH | 4/3 | 2A | CoalCorp | | CC2 | |
| 1288 663/32 | OhiNEWAI | LOTS 1,2 DP 10326 & ALL DP 15564 | 4/3 | 2A | CoalCorp | | CC2 | |
| 1289 33A/65 | OhiNEWAI | LOT 2 DP36936 | 4/3 | 2A | CoalCorp | | CC2 | |
| 1290 43A/435 | OhiNEWAI | ALLOT 353 TAUPIRI PSH SEC 3 BLK VIII RANGIRIRI SD | 4/3 | 2A | CoalCorp | | CC2 | |
| 1291 43D/961 | OhiNEWAI | LOT 1 DPS 4118 | 4/3 | 2A | CoalCorp | | CC2 | |
| 1292 43A/274 | OhiNEWAI | LOT 1 DPS 10295 | 4/3 | 2A | CoalCorp | | CC2 | |
| 1293 42D/981 | OhiNEWAI | PT ALLOT 24, 26 TAUPIRI PSH | 4/3 | 2A | CoalCorp | | CC2 | |
| 1294 42D/976 | OhiNEWAI | ALLOT 638 TAUPIRI PSH | 4/3 | 2A | CoalCorp | | CC2 | |
| 1295 43B/608 | OhiNEWAI | LOT 1 DP 35383 | 4/3 | 2A | CoalCorp | | CC2 | |
| 1296 34D/29 | OhiNEWAI | ALLOT 383,384 TAUPIRI PSH | 4/3 | 2A | CoalCorp | | CC2 | |
| 1297 35A/89 | OhiNEWAI | ALLOTS 385,386,388 PT ALLOT 387 | 4/3 | 2A | CoalCorp | | CC2 | |
| 1298 34D/31 | OhiNEWAI | ALLOT 615 TAUPIRI PSH | 4/3 | 2A | CoalCorp | | CC2 | |
| 1299 34D/30 | OhiNEWAI | ALLOTS 616,617 TAUPIRI PSH | 4/3 | 2A | CoalCorp | | CC2 | |
| 1300 34D/33 | OhiNEWAI | ALLOTS 351,352 TAUPIRI PSH | 4/3 | 2A | CoalCorp | | CC2 | |

Attachment 2: Settlement Land

Deed Of Settlement

| 1 | 2 | 3 | 4 | 5 | 6 | 7 | 8 | 9 |
|-------------------|---------------------|------------|----------|------------|--------------|--------------|-------|-----------|
| Property Detail | Quarter of Transfer | Tftf Basis | Agency | Lease Form | Initial term | Renewal Term | No. | Portfolio |
| 1301 35B/753 | Ohinewai | 4/3 | CoalCorp | | | | CC2 | |
| 1302 34D/32 | Ohinewai | 4/3 | CoalCorp | | | | CC2 | |
| 1303 25D/1148 | Ohinewai | 4/3 | CoalCorp | | | | CC2 | |
| 1143 34A/507 | East | 3/2 | CoalCorp | | | | CEAST | |
| 1144 106/136 | East | 3/2 | CoalCorp | | | | CEAST | |
| 1145 34A/508 | East | 3/2 | CoalCorp | | | | CEAST | |
| 1146 34A/509 | East | 3/2 | CoalCorp | | | | CEAST | |
| 1147 34A/506 | East | 3/2 | CoalCorp | | | | CEAST | |
| 1148 25C/871 Part | Incl Gun Club land | 3/2 | CoalCorp | | | | CEAST | |
| 1149 52D/567 Part | East | 3/2 | CoalCorp | | | | CEAST | |
| 1150 34A/500 | East | 3/2 | CoalCorp | | | | CEAST | |
| 1151 34A/501 | East | 3/2 | CoalCorp | | | | CEAST | |
| 1152 43C/880 | East | 3/2 | CoalCorp | | | | CEAST | |
| 1153 33A/479 | East | 3/2 | CoalCorp | | | | CEAST | |
| 1154 10D/800 | East | 3/2 | CoalCorp | | | | CEAST | |
| 1155 33D/415 | East | 3/2 | CoalCorp | | | | CEAST | |
| 1156 43D/997 | East | 3/2 | CoalCorp | | | | CEAST | |
| 1157 43C/879 | East | 3/2 | CoalCorp | | | | CEAST | |
| 1158 43C/878 | East | 3/2 | CoalCorp | | | | CEAST | |
| 1159 2B/843 | East | 3/2 | CoalCorp | | | | CEAST | |

Attachment 2: Settlement Land

Deed Of Settlement

| 1 | 2 | 3 | 4 | 5 | 6 | 7 | 8 | 9 |
|-------------------|--|-----------|----------|------------|--------------|--------------|-----|-----------|
| Property Detail | Quarter of Transfer | Tfr Basis | Agency | Lease Form | Initial term | Renewal Term | No. | Portfolio |
| 1160 43C/865 | East | 5.3917 | CoalCorp | CEAST | | | | CEAST |
| | LOT 1 DPS 12402 PT LOT 12 DP 23455 | 3/2 | 2A | CoalCorp | | | | CEAST |
| 1161 43C/866 | East | 3.6237 | CoalCorp | CEAST | | | | CEAST |
| | LOT 11 DP 23455 | 3/2 | 2A | CoalCorp | | | | CEAST |
| 1162 44B/158 | East | 1.2275 | CoalCorp | CEAST | | | | CEAST |
| | PT ALLOTS 15,17 TAUPIRI PSH | 3/2 | 2A | CoalCorp | | | | CEAST |
| 1163 43C/877 | East | 11.495 | CoalCorp | CEAST | | | | CEAST |
| | PT ALLOT 14,PT LOT 2 DP3675 LOTS 16 & PT 17 DP5628 | 3/2 | 2A | CoalCorp | | | | CEAST |
| 1164 43C/876 | East | 5.073 | CoalCorp | CEAST | | | | CEAST |
| | LOT 2 DPS 33575 | 3/2 | 2A | CoalCorp | | | | CEAST |
| 1165 47C/306 | East | 6.4378 | CoalCorp | CEAST | | | | CEAST |
| | PT ALLOT 6 TAUPIRI PARISH | 3/2 | 2A | CoalCorp | | | | CEAST |
| 1166 43C/875 | East | 0.3741 | CoalCorp | CEAST | | | | CEAST |
| | LOT 1 DPS 33575 | 3/2 | 2A | CoalCorp | | | | CEAST |
| 1167 43C/874 | East | 0.1783 | CoalCorp | CEAST | | | | CEAST |
| | PT ALLOT 6 TAUPIRI PSH | 3/2 | 2A | CoalCorp | | | | CEAST |
| 1168 43C/873 | East | 0.0531 | CoalCorp | CEAST | | | | CEAST |
| | ALLOT 745 TAUPIRI PSH | 3/2 | 2A | CoalCorp | | | | CEAST |
| 1169 43C/867 | East | 0.2418 | CoalCorp | CEAST | | | | CEAST |
| | PT LOT 1 DPS 18702 | 3/2 | 2A | CoalCorp | | | | CEAST |
| 1170 43C/864 | East | 0.0179 | CoalCorp | CEAST | | | | CEAST |
| | PT LOT 44 DPS 6216 | 3/2 | 2A | CoalCorp | | | | CEAST |
| 1171 43C/872 | East | 0.2503 | CoalCorp | CEAST | | | | CEAST |
| | LOT 1 DPS 37851 | 3/2 | 2A | CoalCorp | | | | CEAST |
| 1172 43C/871 | East | 0.1759 | CoalCorp | CEAST | | | | CEAST |
| | ALLOTS 872,873,874 TAUPIRI PSH | 3/2 | 2A | CoalCorp | | | | CEAST |
| 1173 43C/870 | East | 1.0627 | CoalCorp | CEAST | | | | CEAST |
| | PT LOT 23 DP 23455 | 3/2 | 2A | CoalCorp | | | | CEAST |
| 1174 37D/500 | East | 1.5109 | CoalCorp | CEAST | | | | CEAST |
| | LOT 1 DPS 43122 | 3/2 | 2A | CoalCorp | | | | CEAST |
| 1175 To be issued | East | 3.4702 | CoalCorp | CEAST | | | | CEAST |
| | PT ALLOT 757 SO 57490 | 3/2 | 2A | CoalCorp | | | | CEAST |
| 1176 To be issued | East | 0.2049 | CoalCorp | CEAST | | | | CEAST |
| | BLOCK 12 SO 4574A,SO34064 RANGIRIRI SD | 3/2 | 2A | CoalCorp | | | | CEAST |
| 1177 To be issued | East | 0.1897 | CoalCorp | CEAST | | | | CEAST |
| | PT ALLOT 5 TAUPIRI PSH | 3/2 | 2A | CoalCorp | | | | CEAST |
| 1178 19B/1418 | East | 4.4611 | CoalCorp | CEAST | | | | CEAST |
| | LOT 1 DP 24914 | 3/2 | 2A | CoalCorp | | | | CEAST |
| 1179 To be issued | East | 11.3821 | CoalCorp | CEAST | | | | CEAST |
| | LOTS 5,6,7,10 DP 23455 | 3/2 | 2A | CoalCorp | | | | CEAST |
| 1197 43D/742 | Rotowaro | 11.6188 | CoalCorp | CECNZ | | | | CECNZ |
| | PT ALLOTS 69,74 PEPEPE PSH | 3/2 | 2A | CoalCorp | | | | CECNZ |

Attachment 2: Settlement Land

Deed Of Settlement

| 1 | 2 | 3 | 4 | 5 | 6 | 7 | 8 | 9 |
|------------------|---------------------|--|----------|------------|--------------|--------------|-------|-----------|
| Property Detail | Quarter of Transfer | Tfr Basis | Agency | Lease Form | Initial term | Renewal Term | No. | Portfolio |
| 1198 43D/189 | Rotowaro | LOT 1 DP 36804 | 0.1138 | 3/2 | 2A | CoalCorp | CECNZ | |
| 1201 26B/973 | Rotowaro | PT ALLOT 71 PEPEPE PSH | 0.3897 | 3/2 | 2A | CoalCorp | CECNZ | |
| 1202 33A/64 | Rotowaro | PT ALLOT 71 PEPEPE PSH | 5.6666 | 3/2 | 2A | CoalCorp | CECNZ | |
| 1204 33A/62 Part | Rotowaro | PT ALLOT 68A PEPEPE PSH | 3.6376 | 3/2 | 2A | CoalCorp | CECNZ | |
| 1252 1769/61 | Rotowaro | ALLOT 343 PEPEPE PSH | 0.3281 | 3/2 | 2A | CoalCorp | CECNZ | |
| 1253 1769/65 | Rotowaro | ALLOTS 344, 345 PEPEPE PSH | 0.1985 | 3/2 | 2A | CoalCorp | CECNZ | |
| 1273 23C/194 | West | PT LOT 1 DPS 3964 | 0.9891 | 3/2 | 2A | CoalCorp | CECNZ | |
| 1274 43D/795 | West | ALLOT 37 PEPEPE PARISH | 22.2577 | 3/2 | 2A | CoalCorp | CECNZ | |
| 1275 33A/110 | West | PT LOT 1 DP 23255 | 20.9551 | 3/2 | 2A | CoalCorp | CECNZ | |
| 1276 1400/16 | West | LOT 2 DP 23255 | 22.6876 | 3/2 | 2A | CoalCorp | CECNZ | |
| 1277 43C/868 | West | LOT 1 DPS 4065 | 0.8094 | 3/2 | 2A | CoalCorp | CECNZ | |
| 1278 33C/763 | West | LOTS 1 & 3 DPS 7517 | 4.7846 | 3/2 | 2A | CoalCorp | CECNZ | |
| 1279 33C/596 | West | PT LOT 2 DPS 7517 | 2.9107 | 3/2 | 2A | CoalCorp | CECNZ | |
| 1280 33C/595 | West | ALLOT 322 PEPEPE PSH | 0.0662 | 3/2 | 2A | CoalCorp | CECNZ | |
| 1180 43D/530 | Maramarua | LOT 2 DPS 16785 | 37.6383 | 4/5 | 2A | CoalCorp | CMARA | |
| 1181 5B/1177 | Maramarua | PT SEC. 1S KOPUKU NO 2 SETTLEMENT | 62.9236 | 4/5 | 2A | CoalCorp | CMARA | |
| 1182 5B/1178 | Maramarua | SEC. 10S KOPUKU NO 2 SETTLEMENT | 57.9637 | 4/5 | 2A | CoalCorp | CMARA | |
| 1183 1496/67 | Maramarua | SECS 6S, 18S, 19S KOPUKU NO 2 SETTLEMENT | 153.0116 | 4/5 | 2A | CoalCorp | CMARA | |
| 1184 1430/44 | Rotowaro | LOT 1 DP 1527 | 0.0918 | 3/2 | 2A | CoalCorp | CROTO | |
| 1185 33A/61 | Rotowaro | PT LOT 1 DP 36747 | 0.4605 | 3/2 | 2A | CoalCorp | CROTO | |
| 1186 937/127 | Rotowaro | LOT 2 DP 33572 | 0.1012 | 3/2 | 2A | CoalCorp | CROTO | |
| 1187 1200/30 | Rotowaro | LOT 3 DP 2452 | 1.9295 | 3/2 | 2A | CoalCorp | CROTO | |

Attachment 2: Settlement Land

Deed Of Settlement

| 1 | 2 | 3 | 4 | 5 | 6 | 7 | 8 | 9 |
|-------------------|---------------------|---|---------|------------|--------------|--------------|-------|-----------|
| Property Detail | Quarter of Transfer | Tfr Basis | Agency | Lease Form | Initial term | Renewal Term | No. | Portfolio |
| 1188 869/77 | Rotowaro | LOT 1 DP 33572 | 0.1047 | 3/2 | 2A | CoalCorp | CROTO | |
| 1189 773/207 | Rotowaro | PT ALLOT 80 PEPEPE PSH | 0.0304 | 3/2 | 2A | CoalCorp | CROTO | |
| 1190 883/180 | Rotowaro | PT LOT 1 DP 31221 | 10.799 | 3/2 | 2A | CoalCorp | CROTO | |
| 1191 904/175 | Rotowaro | LOT 1 DP 25019 | 0.1016 | 3/2 | 2A | CoalCorp | CROTO | |
| 1192 657/1 | Rotowaro | LOT 2 DP 25019 | 0.1012 | 3/2 | 2A | CoalCorp | CROTO | |
| 1193 670/225 | Rotowaro | LOT 3 DP 25019 | 0.1012 | 3/2 | 2A | CoalCorp | CROTO | |
| 1194 798/231 | Rotowaro | LOT 4 DP 25019 | 0.1229 | 3/2 | 2A | CoalCorp | CROTO | |
| 1195 33C/598 | Rotowaro | ALLOT 459 PEPEPE PSH | 0.2987 | 3/2 | 2A | CoalCorp | CROTO | |
| 1196 769/278 | Rotowaro | PT ALLOT 69 PEPEPE PSH (DOC) | 0.3898 | 3/2 | 2A | CoalCorp | CROTO | |
| 1199 To be issued | Rotowaro | LOTS 1 - 4 DPS 72092 (ROTOWARO T'SHIP) | 30.6814 | 3/2 | 2A | CoalCorp | CROTO | |
| 1200 43D/540 | Rotowaro | PT ALLOT 78A PEPEPE PSH | 5.0854 | 3/2 | 2A | CoalCorp | CROTO | |
| 1203 33B/331 Part | Rotowaro | PT ALLOT 72 PEPEPE PSH | 16.718 | 3/2 | 2A | CoalCorp | CROTO | |
| 1205 33A/51 | Rotowaro | PT ALLOT 73B PEPEPE PSH | 26.2236 | 3/2 | 2A | CoalCorp | CROTO | |
| 1206 51C/664 Part | Rotowaro | PT LOT 2 DP30314 LOTS 1,2&4 DPS 62002 | 54.4834 | 3/2 | 2A | CoalCorp | CROTO | |
| 1207 773/45 | Rotowaro | PT ALLOT 80 PEPEPE PSH | 3.1641 | 3/2 | 2A | CoalCorp | CROTO | |
| 1208 53D/961 | Rotowaro | LOTS 2 & 4 DP 26226 | 79.723 | 3/2 | 2A | CoalCorp | CROTO | |
| 1209 53D/964 | Rotowaro | SECS 2 & 5 SO 59708 | 515.63 | 3/2 | 2A | CoalCorp | CROTO | |
| 1210 32D/757 | Rotowaro | ALLOTS 363,365,376 PEPEPE PSH | 40.6961 | 3/2 | 2A | CoalCorp | CROTO | |
| 1211 54A/242 Part | Rotowaro | SEC 4 SO 59708 | 120.45 | 3/2 | 2A | CoalCorp | CROTO | |
| 1212 53D/963 | Rotowaro | SEC 3 SO 59708 | 1.297 | 3/2 | 2A | CoalCorp | CROTO | |
| 1213 32D/758 Part | Rotowaro | ALLOT 384 PEPE PARISH | 0.607 | 3/2 | 2A | CoalCorp | CROTO | |

Attachment 2: Settlement Land

Deed Of Settlement

| 1 | 2 | 3 | 4 | 5 | 6 | 7 | 8 | 9 |
|-------------------|---------------------|---|----------|------------|--------------|--------------|-----|-----------|
| Property Detail | Quarter of Transfer | Tfr Basis | Agency | Lease Form | Initial term | Renewal Term | No. | Portfolio |
| 1214 53D/962 | Rotowaro | SECS 1 & 6 SO 59708 | 104.16 | 3/2 | 2A | CoalCorp | | CROTO |
| 1215 54A/243 | Rotowaro | SEC 7 SO 59708 | 0.0629 | 3/2 | 2A | CoalCorp | | CROTO |
| 1216 1276/70 | Rotowaro | ALLOT 78B2A PEPEPE PARISH | 117.5232 | 3/2 | 2A | CoalCorp | | CROTO |
| 1217 33C/768 | Rotowaro | ALLOT 78B1 PEPEPE PARISH | 2.8985 | 3/2 | 2A | CoalCorp | | CROTO |
| 1218 43C/888 Part | Rotowaro | PT ALLOT 168 DP 25447 PEPEPE PSH | 10.9737 | 3/2 | 2A | CoalCorp | | CROTO |
| 1219 34A/503 | Rotowaro | LOT 12 DP 32232 | 0.0872 | 3/2 | 2A | CoalCorp | | CROTO |
| 1220 51C/660 | Rotowaro | LOT 6 DP 62002 | 0.0204 | 3/2 | 2A | CoalCorp | | CROTO |
| 1221 34A/504 | Rotowaro | LOT 8 DP 32232 | 0.0865 | 3/2 | 2A | CoalCorp | | CROTO |
| 1222 51C/662 | Rotowaro | LOTS 3,5 & 7 DP 62002 | 0.1544 | 3/2 | 2A | CoalCorp | | CROTO |
| 1223 933/283 | Rotowaro | ALLOT 280 PEPEPE PSH | 0.7967 | 3/2 | 2A | CoalCorp | | CROTO |
| 1224 810/7 | Rotowaro | PT ALLOT 79 DP 17388 | 19.4709 | 3/2 | 2A | CoalCorp | | CROTO |
| 1225 979/224 | Rotowaro | LOT 1 DP 30083 | 15.7079 | 3/2 | 2A | CoalCorp | | CROTO |
| 1226 979/37 | Rotowaro | LOT 1 DPS 39 | 0.1204 | 3/2 | 2A | CoalCorp | | CROTO |
| 1227 748/58 | Rotowaro | LOT 4 DP 17389 | 0.1533 | 3/2 | 2A | CoalCorp | | CROTO |
| 1228 33A/111 | Rotowaro | LOT 5 DP 17389 | 0.1011 | 3/2 | 2A | CoalCorp | | CROTO |
| 1229 33C/771 | Rotowaro | LOT 6 DP 17389 | 0.1097 | 3/2 | 2A | CoalCorp | | CROTO |
| 1230 33B/332 | Rotowaro | PT ALLOT 79 PEPEPE PSH | 14.5484 | 3/2 | 2A | CoalCorp | | CROTO |
| 1231 51A/560 | Rotowaro | LOTS 1 & 2 DP 17389 | 1.6557 | 3/2 | 2A | CoalCorp | | CROTO |
| 1232 49C/904 | Rotowaro | PT ALLOT 74 PEPEPE PARISH | 0.212 | 3/2 | 2A | CoalCorp | | CROTO |
| 1233 33C/762 Part | Rotowaro | ALLOTS 350,353,354,355,356 PEPEPE PSH | 0.3532 | 3/2 | 2A | CoalCorp | | CROTO |
| 1234 803/13 | Rotowaro | LOT 5 DP 25019 | 0.1011 | 3/2 | 2A | CoalCorp | | CROTO |
| 1235 656/300 | Rotowaro | LOT 6 DP 25019 | 0.1012 | 3/2 | 2A | CoalCorp | | CROTO |
| 1236 659/193 | Rotowaro | LOT 7 DP 25019 | 0.1012 | 3/2 | 2A | CoalCorp | | CROTO |

Attachment 2: Settlement Land

Deed Of Settlement

| 1 | 2 | 3 | 4 | 5 | 6 | 7 | 8 | 9 |
|-------------------|---------------------|-------------------------------|---------|------------|--------------|--------------|-----|-----------|
| Property Detail | Quarter of Transfer | Ttr Basis | Agency | Lease Form | Initial term | Renewal Term | No. | Portfolio |
| 1237 657/67 | Rotowaro | LOT 8 DP 25019 | 0.1042 | 3/2 | 2A | CoalCorp | | CROTO |
| 1238 1201/151 | Rotowaro | LOT 4 DP 2452 | 3.9008 | 3/2 | 2A | CoalCorp | | CROTO |
| 1239 1200/44 | Rotowaro | LOTS 1 & 2 DP 36961 | 0.1809 | 3/2 | 2A | CoalCorp | | CROTO |
| 1240 772/163 | Rotowaro | PT ALLOT 80 PEPEPE PSH | 5.076 | 3/2 | 2A | CoalCorp | | CROTO |
| 1241 533/97 | Rotowaro | PT ALLOT 149 PEPEPE PARISH | 1.62 | 3/2 | 2A | CoalCorp | | CROTO |
| 1242 33A/58 | Rotowaro | LOT 2 DP 15542 | 15.0838 | 3/2 | 2A | CoalCorp | | CROTO |
| 1243 47C/628 | Rotowaro | ALLOT 144A PEPEPE PSH | 1.816 | 3/2 | 2A | CoalCorp | | CROTO |
| 1244 1491/95 | Rotowaro | LOT 1 DPS 5776 | 0.1011 | 3/2 | 2A | CoalCorp | | CROTO |
| 1245 773/57 | Rotowaro | PT ALLOT 80 PEPEPE PSH | 0.4749 | 3/2 | 2A | CoalCorp | | CROTO |
| 1246 52C/358 | Rotowaro | SECS 1 & 2 SO 59515 | 14.127 | 3/2 | 2A | CoalCorp | | CROTO |
| 1247 10B/584 | Rotowaro | ALLOT 144B3 PEPEPE PSH | 0.234 | 3/2 | 2A | CoalCorp | | CROTO |
| 1248 1A/278 | Rotowaro | ALLOT 144B2 PEPEPE PSH | 0.234 | 3/2 | 2A | CoalCorp | | CROTO |
| 1249 27B/348 Part | Rotowaro | PT ALLOT 69 PEPEPE PSH | 5 | 3/2 | 2A | CoalCorp | | CROTO |
| 1250 673/129 | Rotowaro | PT ALLOT 74 PEPEPE PSH | 6.0702 | 3/2 | 2A | CoalCorp | | CROTO |
| 1251 5A/1397 | Rotowaro | ALLOT 367 PEPEPE PSH | 3.7054 | 3/2 | 2A | CoalCorp | | CROTO |
| 1254 8A/1231 Part | Rotowaro | LOT 1 DPS 7514 | 1.7 | 3/2 | 2A | CoalCorp | | CROTO |
| 1255 10B/585 | Rotowaro | ALLOT 144 B1 PEPEPE PSH | 0.1872 | 3/2 | 2A | CoalCorp | | CROTO |
| 1256 10C/675 | Rotowaro | ALLOT 144B2 & 4 PEPEPE PSH | 1.1609 | 3/2 | 2A | CoalCorp | | CROTO |
| 1257 43D/542 | Weavers | ALLOT 46A PEPEPE PSH | 10.6382 | 3/2 | 2A | CoalCorp | | CWEAVERS |
| 1258 43D/541 | Weavers | ALLOT 46B PEPEPE PSH | 10.6382 | 3/2 | 2A | CoalCorp | | CWEAVERS |
| 1259 46B/157 | Weavers | PT ALLOT 48 PEPEPE PSH | 20.4795 | 3/2 | 2A | CoalCorp | | CWEAVERS |

Attachment 2: Settlement Land

Deed Of Settlement

| 1 | 2 | 3 | 4 | 5 | 6 | 7 | 8 | 9 |
|-------------------|---------------------|----------------------------------|---------|------------|--------------|--------------|-----|-----------|
| Property Detail | Quarter of Transfer | Trfr Basis | Agency | Lease Form | Initial term | Renewal Term | No. | Portfolio |
| 1260 33A/70 | Weavers | PT ALLOT 48 PEPEPE PSH | 0.4046 | 3/2 | 2A | CoalCorp | | CWEAVERS |
| 1261 33A/69 | Weavers | LOT 1 DPS 3204 | 0.8093 | 3/2 | 2A | CoalCorp | | CWEAVERS |
| 1262 33A/71 | Weavers | LOT 2 DPS 3204 | 0.8093 | 3/2 | 2A | CoalCorp | | CWEAVERS |
| 1263 43C/863 | Weavers | PT ALLOT 49 PEPEPE PSH | 7.1845 | 3/2 | 2A | CoalCorp | | CWEAVERS |
| 1264 43D/543 | Weavers | PT ALLOT 229 PEPEPE PSH | 0.3748 | 3/2 | 2A | CoalCorp | | CWEAVERS |
| 1265 43C/862 | Weavers | PT ALLOTS 47,163 PEPEPE PSH | 7.2687 | 3/2 | 2A | CoalCorp | | CWEAVERS |
| 1266 50A/807 | Weavers | SEC 1 SO 58281 | 22.98 | 3/2 | 2A | CoalCorp | | CWEAVERS |
| 1267 50B/714 Part | Weavers | LOT 2 DPS 61669 | 42.88 | 3/2 | 2A | CoalCorp | | CWEAVERS |
| 1268 1700/74 | Weavers | PT ALLOT 47 PEPEPE PSH | 16.1145 | 3/2 | 2A | CoalCorp | | CWEAVERS |
| 1269 50B/544 | Weavers | SEC 1 SO57579 & SEC 1 SO57480 | 3.3695 | 3/2 | 2A | CoalCorp | | CWEAVERS |
| 1270 258/16 | Weavers | PT ALLOT 47 DP 10728 | 1.2313 | 3/2 | 2A | CoalCorp | | CWEAVERS |
| 1271 43C/869 | West | SEC 56 BLK V11 RANGIRIRI SD | 97.13 | 3/2 | 2A | CoalCorp | | CWEST |
| 1272 23C/925 | West | SEC 55 BLK V11 RANGIRIRI SD | 4.1455 | 3/2 | 2A | CoalCorp | | CWEST |

Attachment 2: Settlement Land

Deed Of Settlement

| 1 | 2 | 3 | 4 | 5 | 6 | 7 | 8 | 9 |
|--|---------------------|------------|---------------------|------------|--------------|--------------|-----|-----------|
| Property Detail | Quarter of Transfer | Trfr Basis | Agency | Lease Form | Initial term | Renewal Term | No. | Portfolio |
| 1500 55A/772 Part m2 to be transferred subject to survey Weavers | | | | | | | | |
| Rotowaro | | | | | | | | |
| See attachd CT 55A/772. Area Shaded and labelled A on PT Lot 6 | 3/2 | 2A | Mine Rescue Service | | 20 | 20 | 2 | MINES 1 |

Attachment 3: Improved Land

Deed Of Settlement

| 1 | 2 | 3 | 4 | 5 | 6 | 7 | 8 | 9 |
|---|---------------------|------------|----------|------------|--------------|--------------|-----|-----------|
| Property Detail | Quarter of Transfer | Trfr Basis | Agency | Lease Form | Initial term | Renewal Term | No. | Portfolio |
| 1480 1C/1377 | | | | | | | | |
| Dwelling, Farm improvements | 3/2 | 1A | CoalCorp | | | | | CSURPLUS |
| East | | | | | | | | |
| PT LOT 2, LOT 3, PT LOT 4 DP 28953 | | | | | | | | |
| 0.7877 | | | | | | | | |
| 1481 43D/698 | | | | | | | | |
| Maramarua | 3/2 | 1A | CoalCorp | | | | | CSURPLUS |
| PT LOTS 12-14, LOTS 5&16 DP 14306 LOT 1 DPS 24784 | | | | | | | | |
| 133.3185 | | | | | | | | |
| 1482 71D/658 | | | | | | | | |
| Pine Trees belong to GlenCoal | 3/2 | 1A | CoalCorp | | | | | CSURPLUS |
| Maramarua | | | | | | | | |
| LOTS 2,4 DP 15311 | | | | | | | | |
| 9.409 | | | | | | | | |
| 1483 45B/647 | | | | | | | | |
| Rotowaro | 3/2 | 1A | CoalCorp | | | | | CSURPLUS |
| PT ALLOTS 202,204 PEPEPE PARISH | | | | | | | | |
| 128.3332 | | | | | | | | |
| 1484 716/200 | | | | | | | | |
| Acala Trees | 3/2 | 1A | CoalCorp | | | | | CSURPLUS |
| Rotowaro | | | | | | | | |
| PT ALLOT 203 PEPEPE PSH | | | | | | | | |
| 71.5812 | | | | | | | | |
| 1485 626/286 | | | | | | | | |
| Rotowaro | 3/2 | 1A | CoalCorp | | | | | CSURPLUS |
| ALLOT 201 PEPEPE PSH | | | | | | | | |
| 94.6433 | | | | | | | | |
| 1486 51C/664 Part | | | | | | | | |
| Rotowaro | 3/2 | 1A | CoalCorp | | | | | CSURPLUS |
| PT LOT 2 DP30314 LOTS 1,2&4 DPS 62002 | | | | | | | | |
| 126.6 | | | | | | | | |
| 1487 54A/242 Part | | | | | | | | |
| Dwelling, Pine Trees, Farm Improvements | 3/2 | 1A | CoalCorp | | | | | CSURPLUS |
| Rotowaro | | | | | | | | |
| SEC 4 SO 59708 | | | | | | | | |
| 28.9 | | | | | | | | |
| 1488 32D/758 Part | | | | | | | | |
| Rotowaro | 3/2 | 1A | CoalCorp | | | | | CSURPLUS |
| ALLOTS 297,307 AND 366 PEPEPE PARISH | | | | | | | | |
| 278.0008 | | | | | | | | |
| 1489 43C/888 Part | | | | | | | | |
| Dwelling | 3/2 | 1A | CoalCorp | | | | | CSURPLUS |
| Rotowaro | | | | | | | | |
| PT ALLOT 168 DP 25447 PEPEPE PSH | | | | | | | | |
| 12.5 | | | | | | | | |
| 1490 11B/772 | | | | | | | | |
| Pine Trees | 3/2 | 1A | CoalCorp | | | | | CSURPLUS |
| Rotowaro | | | | | | | | |
| ALLOT 81 PEPEPE PARISH | | | | | | | | |
| 21.8252 | | | | | | | | |
| 1491 27B/348 Part | | | | | | | | |
| Rotowaro | 3/2 | 1A | CoalCorp | | | | | CSURPLUS |
| PT ALLOT 69 PEPEPE PSH | | | | | | | | |
| 52.7832 | | | | | | | | |
| 1492 8A/1231 Part | | | | | | | | |
| Rotowaro | 3/2 | 1A | CoalCorp | | | | | CSURPLUS |
| LOT 1 DPS 7514 | | | | | | | | |
| 4.2565 | | | | | | | | |
| 1493 50B/714 Part | | | | | | | | |
| Office Bldg | 3/2 | 1A | CoalCorp | | | | | CSURPLUS |
| Weavers | | | | | | | | |
| LOT 1 DPS 61669 | | | | | | | | |
| 1.357 | | | | | | | | |

Attachment 3: Improved Land

Deed Of Settlement

| 1 | 2 | 3 | 4 | 5 | 6 | 7 | 8 | 9 |
|---|---------------------|-----------|------------------|------------|--------------|--------------|-----|-----------|
| Property Detail | Quarter of Transfer | Tfr Basis | Agency | Lease Form | Initial term | Renewal Term | No. | Portfolio |
| 1494 50B/714 Part Stores Bldg, Workshop Bldg, Laboratory. | 3/2 | 1A | CoalCorp | | | | | CSURPLUS |
| 1496 1441/100 Weavers | 3/2 | 1A | CoalCorp | | | | | CSURPLUS |
| 1497 603/214 Weavers | 3/2 | 1A | CoalCorp | | | | | CSURPLUS |
| 1498 45B/648 Weavers | 3/2 | 1A | CoalCorp | | | | | CSURPLUS |
| 1499 55A/772 Part m2 to be transferred subject to survey, not including Mines Rescue Station or land swapped by State Coal for 12/25 of Frank Williams Estate | 3/2 | 1A | CoalCorp | | | | | CSURPLUS |
| LOT 3 DPS 61669 LOTS 27,28,30 DP 22510 LOT 29 DP 22510 ALLOT 9C PEPEPE PARISH PT LOT 3 DP1053, PT LOT 7 DP 1278, PT LOT 6 DP 15829, PT LOT DP 25266, PT LOT 1 DP28499, PT ALLOTMENTS 9 & ALLOTS 527-531 PEPEPE PSH & SEC 1 SO 59583. DOES NOT INCLUDE MINES RESCUE STATION, AND PART OF PT 1 DP 28499. BOTH AREAS ARE SHADED ON CT 55A/772 | | | | | | | | |
| 1304 25C/607 1 Bailey St,Dwelling | 4/5 | 1D | Crown - Coalcorp | | | | | CSURPLUS1 |
| 1306 Gaz74-1120 Baker Block, Land | 4/5 | 1D | Crown - Coalcorp | | | | | CSURPLUS1 |
| 1315 27B/9 2 Brownlie Cres, Section | 4/5 | 1D | Crown - Coalcorp | | | | | CSURPLUS1 |

Attachment 3: Improved Land

Deed Of Settlement

| 1 | 2 | 3 | 4 | 5 | 6 | 7 | 8 | 9 |
|-----------------|-----------------------------|-----------|------------------|------------|--------------|--------------|-----|-----------|
| Property Detail | Quarter of Transfer | Trf Basis | Agency | Lease Form | Initial term | Renewal Term | No. | Portfolio |
| 1445 42B/940 | 23 Russell Rd, Dwelling | 1D | Crown - Coalcorp | | | | | CSURPLUS1 |
| 1446 556/286 | 37 Russell Rd, Dwelling | 1D | Crown - Coalcorp | | | | | CSURPLUS1 |
| 1447 42C/5 | 57 Russell Rd, Dwelling | 1D | Crown - Coalcorp | | | | | CSURPLUS1 |
| 1448 42B/949 | 68 Russell Rd, Dwelling | 1D | Crown - Coalcorp | | | | | CSURPLUS1 |
| 1449 42C/366 | 76 Russell Rd, Dwelling | 1D | Crown - Coalcorp | | | | | CSURPLUS1 |
| 1450 42C/370 | 77 Russell Rd, Dwelling | 1D | Crown - Coalcorp | | | | | CSURPLUS1 |
| 1451 1108/194 | 79 Russell Rd, Dwelling | 1D | Crown - Coalcorp | | | | | CSURPLUS1 |
| 1452 42B/938 | 82 Russell Rd, Dwelling | 1D | Crown - Coalcorp | | | | | CSURPLUS1 |
| 1453 6D/2 | 94 Russell Rd, Dwelling | 1D | Crown - Coalcorp | | | | | CSURPLUS1 |
| 1454 42C/149 | 111 Russell Rd, Section | 1D | Crown - Coalcorp | | | | | CSURPLUS1 |
| 1455 32A/613 | 116 Russell Rd, Section | 1D | Crown - Coalcorp | | | | | CSURPLUS1 |
| 1456 42B/445 | 119 Russell Rd, Dwelling | 1D | Crown - Coalcorp | | | | | CSURPLUS1 |
| 1457 13B/1020 | 120 Russell Rd, Section | 1D | Crown - Coalcorp | | | | | CSURPLUS1 |
| 1458 42B/989 | 124 Russell Rd, Dwelling | 1D | Crown - Coalcorp | | | | | CSURPLUS1 |
| 1465 42B/934 | 5 Stirling Pl, Dwelling | 1D | Crown - Coalcorp | | | | | CSURPLUS1 |
| 1305 42C/30 | 84 Bailey St, Section | 1A | Crown - Coalcorp | | | | | CSURPLUS2 |
| 1307 24B/711 | 32 Baker St, Section | 1A | Crown - Coalcorp | | | | | CSURPLUS2 |
| 1308 24B/738 | 35 Baker St, Section | 1A | Crown - Coalcorp | | | | | CSURPLUS2 |
| 1309 42C/915 | 7 Blundell Pl, Dwelling | 1A | Crown - Coalcorp | | | | | CSURPLUS2 |
| 1310 42C/304 | 9 Blundell Pl, Dwelling | 1A | Crown - Coalcorp | | | | | CSURPLUS2 |
| 1311 42C/16 | 30 Blundell Pl, Section | 1A | Crown - Coalcorp | | | | | CSURPLUS2 |
| 1312 42C/302 | 31 Blundell Pl, Section | 1A | Crown - Coalcorp | | | | | CSURPLUS2 |
| 1313 42C/299 | 35 Blundell Pl, Dwelling | 1A | Crown - Coalcorp | | | | | CSURPLUS2 |
| 1314 24B/713 | 4 Bond Pl, Section | 1A | Crown - Coalcorp | | | | | CSURPLUS2 |
| 1320 42C/285 | 6 Caesar Roose Pl, Section | 1A | Crown - Coalcorp | | | | | CSURPLUS2 |
| 1321 24B/829 | 17 Caesar Roose Pl, Section | 1A | Crown - Coalcorp | | | | | CSURPLUS2 |
| 1322 24B/826 | 23 Caesar Roose Pl, Section | 1A | Crown - Coalcorp | | | | | CSURPLUS2 |
| 1323 24B/825 | 25 Caesar Roose Pl, Section | 1A | Crown - Coalcorp | | | | | CSURPLUS2 |

Attachment 3: Improved Land

Deed Of Settlement

| 1 | 2 | 3 | 4 | 5 | 6 | 7 | 8 | 9 |
|-----------------|-----------------------------|-----------|------------------|------------|--------------|--------------|-----|-----------|
| Property Detail | Quarter of Transfer | Tfr Basis | Agency | Lease Form | Initial term | Renewal Term | No. | Portfolio |
| 1324 24B/808 | 30 Caesar Roose Pl,Section | 1A | Crown - Coalcorp | | | | | CSURPLUS2 |
| 1325 24B/816 | 41 Caesar Roose Pl,Section | 1A | Crown - Coalcorp | | | | | CSURPLUS2 |
| 1326 24B/815 | 43 Caesar Roose Pl,Section | 1A | Crown - Coalcorp | | | | | CSURPLUS2 |
| 1331 42D/463 | 4A George Clay Pl,Dwelling | 1A | Crown - Coalcorp | | | | | CSURPLUS2 |
| | PL LOT 12 DPS | | | | | | | |
| | 37693 FLAT 1 DPS | | | | | | | |
| | 51062 | | | | | | | |
| 1332 42D/464 | 4B George Clay Pl,Dwelling | 1A | Crown - Coalcorp | | | | | CSURPLUS2 |
| | LOT 12 DPS 37693 | | | | | | | |
| | FLAT 2 DPS 51062 | | | | | | | |
| 1333 42C/737 | 2 George Clay Pl,Dwelling | 1A | Crown - Coalcorp | | | | | CSURPLUS2 |
| 1334 43C/544 | 10 George Clay Pl,Dwelling | 1A | Crown - Coalcorp | | | | | CSURPLUS2 |
| | LOT 13 DPS 37693 | | | | | | | |
| | LOT 1 DP 32345 PT | | | | | | | |
| | ALLOTS 38,38A & 39 | | | | | | | |
| 1335 42C/744 | 15 George Clay Pl,Dwelling | 1A | Crown - Coalcorp | | | | | CSURPLUS2 |
| | LOT 1 DP 32345 PT | | | | | | | |
| | ALLOTS 38,38A & 39 | | | | | | | |
| 1336 43C/544 | 12A George Clay Pl,Dwelling | 1A | Crown - Coalcorp | | | | | CSURPLUS2 |
| | LOT 1 DP 32345 PT | | | | | | | |
| | ALLOTS 38,38A & 39 | | | | | | | |
| 1337 43C/544 | 12B George Clay Pl,Dwelling | 1A | Crown - Coalcorp | | | | | CSURPLUS2 |
| | LOT 1 DP 32345 PT | | | | | | | |
| | ALLOTS 38,38A & 39 | | | | | | | |
| 1338 43C/544 | 12C George Clay Pl,Dwelling | 1A | Crown - Coalcorp | | | | | CSURPLUS2 |
| | LOT 1 DP 32345 PT | | | | | | | |
| | ALLOTS 38,38A & 39 | | | | | | | |
| 1339 42D/172 | Great South Rd,Dwelling | 1A | Crown - Coalcorp | | | | | CSURPLUS2 |
| 1340 949/161 | 209 Hakanoa St,Section | 1A | Crown - Coalcorp | | | | | CSURPLUS2 |
| | LOT 17 BLK II DP | | | | | | | |
| | 9386 | | | | | | | |
| 1341 24A/954 | 13 Harlock Pl,Dwelling | 1A | Crown - Coalcorp | | | | | CSURPLUS2 |
| 1342 24A/929 | 19 Harlock Pl,Dwelling | 1A | Crown - Coalcorp | | | | | CSURPLUS2 |
| 1343 42D/272 | 62 Hartis St,Dwelling | 1A | Crown - Coalcorp | | | | | CSURPLUS2 |
| 1344 43D/241 | 3 Hartis Ave,Dwelling | 1A | Crown - Coalcorp | | | | | CSURPLUS2 |
| 1345 43D/231 | 6 Hartis Ave,Dwelling | 1A | Crown - Coalcorp | | | | | CSURPLUS2 |
| 1346 43D/232 | 8 Hartis Ave,Dwelling | 1A | Crown - Coalcorp | | | | | CSURPLUS2 |
| 1347 43D/234 | 12 Hartis Ave,Section | 1A | Crown - Coalcorp | | | | | CSURPLUS2 |
| 1348 43D/243 | 14 Hartis Ave,Dwelling | 1A | Crown - Coalcorp | | | | | CSURPLUS2 |
| 1349 43D/254 | 16 Hartis Ave,Section | 1A | Crown - Coalcorp | | | | | CSURPLUS2 |
| 1350 43D/328 | 17 Hartis Ave,Section | 1A | Crown - Coalcorp | | | | | CSURPLUS2 |
| 1351 43D/321 | 18 Hartis Ave,Section | 1A | Crown - Coalcorp | | | | | CSURPLUS2 |
| | LOT 20 DPS 50879 | | | | | | | |

Attachment 3: Improved Land

Deed Of Settlement

1

| Property Detail | 2 | 3 | 4 | 5 | 6 | 7 | 8 | 9 |
|-----------------|------------------------------|-----------|------------------|------------|--------------|--------------|-----|-----------|
| | Quarter of Transfer | Tfr Basis | Agency | Lease Form | Initial term | Renewal Term | No. | Portfolio |
| 1352 43D/327 | 19 Hartis Ave, Section | 1A | Crown - Coalcorp | | | | | CSURPLUS2 |
| 1353 43D/322 | 20 Hartis Ave, Section | 1A | Crown - Coalcorp | | | | | CSURPLUS2 |
| 1354 43D/326 | 21 Hartis Ave, Section | 1A | Crown - Coalcorp | | | | | CSURPLUS2 |
| 1355 43D/323 | 22 Hartis Ave, Section | 1A | Crown - Coalcorp | | | | | CSURPLUS2 |
| 1356 43D/354 | 23 Hartis Ave, Section | 1A | Crown - Coalcorp | | | | | CSURPLUS2 |
| 1357 43D/324 | 24 Hartis Ave, Section | 1A | Crown - Coalcorp | | | | | CSURPLUS2 |
| 1358 43D/355 | 25 Hartis Ave, Section | 1A | Crown - Coalcorp | | | | | CSURPLUS2 |
| 1359 43D/325 | 26 Hartis Ave, Section | 1A | Crown - Coalcorp | | | | | CSURPLUS2 |
| 1360 43D/353 | 27 Hartis Ave, Section | 1A | Crown - Coalcorp | | | | | CSURPLUS2 |
| 1361 43D/344 | 28 Hartis Ave, Section | 1A | Crown - Coalcorp | | | | | CSURPLUS2 |
| 1362 43D/352 | 29 Hartis Ave, Section | 1A | Crown - Coalcorp | | | | | CSURPLUS2 |
| 1363 43D/345 | 30 Hartis Ave, Section | 1A | Crown - Coalcorp | | | | | CSURPLUS2 |
| 1364 43D/350 | 31 Hartis Ave, Section | 1A | Crown - Coalcorp | | | | | CSURPLUS2 |
| 1365 43D/346 | 32 Hartis Ave, Section | 1A | Crown - Coalcorp | | | | | CSURPLUS2 |
| 1366 43D/351 | 33 Hartis Ave, Section | 1A | Crown - Coalcorp | | | | | CSURPLUS2 |
| 1367 43D/347 | 34 Hartis Ave, Section | 1A | Crown - Coalcorp | | | | | CSURPLUS2 |
| 1368 43D/349 | 35 Hartis Ave, Section | 1A | Crown - Coalcorp | | | | | CSURPLUS2 |
| 1369 43D/348 | 36 Hartis Ave, Section | 1A | Crown - Coalcorp | | | | | CSURPLUS2 |
| 1370 43D/376 | 37 Hartis Ave, Section | 1A | Crown - Coalcorp | | | | | CSURPLUS2 |
| 1371 43D/375 | 39 Hartis Ave, Section | 1A | Crown - Coalcorp | | | | | CSURPLUS2 |
| 1372 43D/235 | 5A Hartis Ave, Dwelling | 1A | Crown - Coalcorp | | | | | CSURPLUS2 |
| 1377 21B/1279 | 81 James Henry Cres, Section | 1A | Crown - Coalcorp | | | | | CSURPLUS2 |
| 1378 45C/853 | Kimihia Rd, Section | 1A | Crown - Coalcorp | | | | | CSURPLUS2 |
| 1379 43D/236 | 1 Matai Pl, Dwelling | 1A | Crown - Coalcorp | | | | | CSURPLUS2 |
| 1380 43D/329 | 2 Matai Pl, Section | 1A | Crown - Coalcorp | | | | | CSURPLUS2 |
| 1381 43D/330 | 4 Matai Pl, Section | 1A | Crown - Coalcorp | | | | | CSURPLUS2 |
| 1382 43D/336 | 5 Matai Pl, Dwelling | 1A | Crown - Coalcorp | | | | | CSURPLUS2 |
| 1383 43D/335 | 7 Matai Pl, Section | 1A | Crown - Coalcorp | | | | | CSURPLUS2 |
| 1384 43D/332 | 8 Matai Pl, Section | 1A | Crown - Coalcorp | | | | | CSURPLUS2 |

Attachment 3: Improved Land

Deed Of Settlement

| 1 | 2 | 3 | 4 | 5 | 6 | 7 | 8 | 9 |
|-----------------|--------------------------|--------------------------------------|--------|------------|--------------|------------------|-----------|-----------|
| Property Detail | Quarter of Transfer | Tfr Basis | Agency | Lease Form | Initial term | Renewal Term | No. | Portfolio |
| 1385 43D/334 | 9 Matai Pl,Section | LOT 74 DPS 50879 | 0.079 | 4/5 | 1A | Crown - Coalcorp | CSURPLUS2 | |
| 1386 26A/354 | 6 Mcdiarnid Cr,Section | LOT 33 DPS 27897 | 0.0633 | 4/5 | 1A | Crown - Coalcorp | CSURPLUS2 | |
| 1387 26A/338 | 19 Mcdiarnid Pl,Section | LOT 54 DPS 27896 | 0.0701 | 4/5 | 1A | Crown - Coalcorp | CSURPLUS2 | |
| 1388 43B/272 | 4 Meadows Lane,Dwelling | LOT 246 DPS 26264 | 0.1296 | 4/5 | 1A | Crown - Coalcorp | CSURPLUS2 | |
| 1389 29A/887 | 6 Meadows Lane,Dwelling | LOT 247 DPS 25264 & ROW | 0.1204 | 4/5 | 1A | Crown - Coalcorp | CSURPLUS2 | |
| 1390 42D/275 | 8 Meadows Lane,Dwelling | LOT 248 DPS 25264 & ROW | 0.111 | 4/5 | 1A | Crown - Coalcorp | CSURPLUS2 | |
| 1391 33C/71 | 10 Meadows Lane,Dwelling | LOT 249 DPS 25264 - SO 56593 | 0.0878 | 4/5 | 1A | Crown - Coalcorp | CSURPLUS2 | |
| 1393 24B/709 | 3 O'Leary Pl,Section | LOT 188 DPS 26235 | 0.0674 | 4/5 | 1A | Crown - Coalcorp | CSURPLUS2 | |
| 1394 24B/748 | 34 Paki St,Dwelling | LOT 6 DPS 26173 | 0.0696 | 4/5 | 1A | Crown - Coalcorp | CSURPLUS2 | |
| 1395 43C/544 | 30 Parry St,Dwelling | LOT 1 DP 32345 PT ALLOTS 38,38A & 39 | | 4/5 | 1A | Crown - Coalcorp | CSURPLUS2 | |
| 1396 43C/544 | 28B Parry St,Dwelling | LOT 1 DP 32345 PT ALLOTS 38,38A & 39 | | 4/5 | 1A | Crown - Coalcorp | CSURPLUS2 | |
| 1397 43C/544 | 28C Parry St,Dwelling | LOT 1 DP 32345 PT ALLOTS 38,38A & 39 | | 4/5 | 1A | Crown - Coalcorp | CSURPLUS2 | |
| 1398 43C/544 | 28D Parry St,Dwelling | LOT 1 DP 32345 PT ALLOTS 38,38A & 39 | | 4/5 | 1A | Crown - Coalcorp | CSURPLUS2 | |
| 1399 43C/544 | 28E Parry St,Dwelling | LOT 1 DP 32345 PT ALLOTS 38,38A & 39 | | 4/5 | 1A | Crown - Coalcorp | CSURPLUS2 | |
| 1400 43C/544 | 28F Parry St,Dwelling | LOT 1 DP 32345 PT ALLOTS 38,38A & 39 | | 4/5 | 1A | Crown - Coalcorp | CSURPLUS2 | |
| 1401 42D/57 | 31 Porrit Ave,Dwelling | LOT 14 DPS 22938 | 0.0796 | 4/5 | 1A | Crown - Coalcorp | CSURPLUS2 | |
| 1402 42C/294 | 32 Porrit Ave,Section | LOT 3 DPS 22938 | 0.0768 | 4/5 | 1A | Crown - Coalcorp | CSURPLUS2 | |
| 1403 42C/13 | 34 Porrit Ave,Section | LOT 2 DPS 22938 | 0.088 | 4/5 | 1A | Crown - Coalcorp | CSURPLUS2 | |
| 1404 43D/374 | 1 Rata Ave,Section | LOT 56 DPS 50881 | 0.0602 | 4/5 | 1A | Crown - Coalcorp | CSURPLUS2 | |
| 1405 43D/356 | 2 Rata Ave,Section | LOT 38 DPS 50881 | 0.0665 | 4/5 | 1A | Crown - Coalcorp | CSURPLUS2 | |
| 1406 43D/357 | 4 Rata Ave,Section | LOT 39 DPS 50881 | 0.0601 | 4/5 | 1A | Crown - Coalcorp | CSURPLUS2 | |
| 1407 43D/373 | 5 Rata Ave,Section | LOT 55 DPS 50881 | 0.06 | 4/5 | 1A | Crown - Coalcorp | CSURPLUS2 | |
| 1408 43D/358 | 6 Rata Ave,Section | LOT 40 DPS 50881 | 0.0621 | 4/5 | 1A | Crown - Coalcorp | CSURPLUS2 | |
| 1409 43D/372 | 7 Rata Ave,Section | LOT 54 DPS 50881 | 0.0602 | 4/5 | 1A | Crown - Coalcorp | CSURPLUS2 | |

Attachment 3: Improved Land

Deed Of Settlement

1

| Property Detail | 2 | 3 | 4 | 5 | 6 | 7 | 8 | 9 |
|-----------------|---|------------|------------------|------------|--------------|--------------|-----|-----------|
| | Quarter of Transfer | Trfr Basis | Agency | Lease Form | Initial term | Renewal Term | No. | Portfolio |
| 1410 43D/359 | 8 Rata Ave, Section | 1A | Crown - Coalcorp | | | | | CSURPLUS2 |
| 1411 43D/371 | 9 Rata Ave, Section | 1A | Crown - Coalcorp | | | | | CSURPLUS2 |
| 1412 43D/360 | 10 Rata Ave, Section | 1A | Crown - Coalcorp | | | | | CSURPLUS2 |
| 1413 43D/370 | 11 Rata Ave, Section | 1A | Crown - Coalcorp | | | | | CSURPLUS2 |
| 1414 43D/361 | 12 Rata Ave, Section | 1A | Crown - Coalcorp | | | | | CSURPLUS2 |
| 1415 43D/369 | 13 Rata Ave, Section | 1A | Crown - Coalcorp | | | | | CSURPLUS2 |
| 1416 43D/362 | 14 Rata Ave, Section | 1A | Crown - Coalcorp | | | | | CSURPLUS2 |
| 1417 43D/368 | 15 Rata Ave, Section | 1A | Crown - Coalcorp | | | | | CSURPLUS2 |
| 1418 43D/363 | 16 Rata Ave, Section | 1A | Crown - Coalcorp | | | | | CSURPLUS2 |
| 1419 43D/364 | 18 Rata Ave, Section | 1A | Crown - Coalcorp | | | | | CSURPLUS2 |
| 1420 43D/365 | 20 Rata Ave, Section | 1A | Crown - Coalcorp | | | | | CSURPLUS2 |
| 1421 43D/366 | 22 Rata Ave, Section | 1A | Crown - Coalcorp | | | | | CSURPLUS2 |
| 1422 43D/367 | 24 Rata Ave, Section | 1A | Crown - Coalcorp | | | | | CSURPLUS2 |
| 1423 43D/251 | 2 Rimu Ave, Section | 1A | Crown - Coalcorp | | | | | CSURPLUS2 |
| 1424 43D/343 | 3 Rimu Ave, Section | 1A | Crown - Coalcorp | | | | | CSURPLUS2 |
| 1425 45C/854 | 4 Rimu Ave, Section | 1A | Crown - Coalcorp | | | | | CSURPLUS2 |
| 1426 43D/342 | 5 Rimu Ave, Section | 1A | Crown - Coalcorp | | | | | CSURPLUS2 |
| 1427 45C/855 | 6 Rimu Ave, Section | 1A | Crown - Coalcorp | | | | | CSURPLUS2 |
| 1428 43D/340 | 7 Rimu Ave, Section | 1A | Crown - Coalcorp | | | | | CSURPLUS2 |
| 1429 45C/856 | 8 Rimu Ave, Section | 1A | Crown - Coalcorp | | | | | CSURPLUS2 |
| 1430 43D/341 | 9 Rimu Ave, Section | 1A | Crown - Coalcorp | | | | | CSURPLUS2 |
| 1431 45C/857 | 10 Rimu Ave, Section | 1A | Crown - Coalcorp | | | | | CSURPLUS2 |
| 1459 42B/939 | 169 Russell Rd, Dwelling | 1A | Crown - Coalcorp | | | | | CSURPLUS2 |
| 1460 42C/369 | 171 Russell Rd, Dwelling | 1A | Crown - Coalcorp | | | | | CSURPLUS2 |
| 1461 16B/1410 | 194 Russell Rd, Section | 1A | Crown - Coalcorp | | | | | CSURPLUS2 |
| 1462 22D/666 | 118B Russell Rd, Dwelling area included in OTS 1463 | 1A | Crown - Coalcorp | | | | | CSURPLUS2 |
| 1463 43A/562 | 118C Russell Rd, Dwelling | 1A | Crown - Coalcorp | | | | | CSURPLUS2 |
| 1464 24A/223 | 5 Scurr Pl, Section | 1A | Crown - Coalcorp | | | | | CSURPLUS2 |

Attachment 3: Improved Land

Deed Of Settlement

| 1 | 2 | 3 | 4 | 5 | 6 | 7 | 8 | 9 |
|-----------------|------------------------|------------|------------------|------------|--------------|--------------|-----|-----------|
| Property Detail | Quarter of Transfer | Trfr Basis | Agency | Lease Form | Initial term | Renewal Term | No. | Portfolio |
| 1466 43D/253 | 3 Totara Tee, Section | 1A | Crown - Coalcorp | | | | | CSURPLUS2 |
| 1467 43D/244 | 4 Totara Tee, Section | 1A | Crown - Coalcorp | | | | | CSURPLUS2 |
| 1468 43D/252 | 5 Totara Tee, Section | 1A | Crown - Coalcorp | | | | | CSURPLUS2 |
| 1469 43D/245 | 6 Totara Tee, Section | 1A | Crown - Coalcorp | | | | | CSURPLUS2 |
| 1470 43D/246 | 8 Totara Tee, Section | 1A | Crown - Coalcorp | | | | | CSURPLUS2 |
| 1471 43D/250 | 9 Totara Tee, Section | 1A | Crown - Coalcorp | | | | | CSURPLUS2 |
| 1472 43D/247 | 10 Totara Tee, Section | 1A | Crown - Coalcorp | | | | | CSURPLUS2 |
| 1473 43D/248 | 12 Totara Tee, Section | 1A | Crown - Coalcorp | | | | | CSURPLUS2 |
| 1474 43D/249 | 14 Totara Tee, Section | 1A | Crown - Coalcorp | | | | | CSURPLUS2 |

Attachment 3: Improved Land

Deed Of Settlement

| 1 | 2 | 3 | 4 | 5 | 6 | 7 | 8 | 9 |
|-----------------|---------------------|-----------|--------|------------|--------------|--------------|-----|-----------|
| Property Detail | Quarter of Transfer | Tfr Basis | Agency | Lease Form | Initial term | Renewal Term | No. | Portfolio |

1475 42B/992 5 Vincent Aspey Pl, Section LOT 145 DPS27367 0.0717 4/5 1D Crown - DOSLI CD1

Attachment 3: Improved Land

Deed Of Settlement

| 1 | 2 | 3 | 4 | 5 | 6 | 7 | 8 | 9 |
|-----------------|-----------------------------|-------------------|--------|------------|--------------|---------------|-----|-----------|
| Property Detail | Quarter of Transfer | Trfr Basis | Agency | Lease Form | Initial term | Renewal Term | No. | Portfolio |
| 1476 25A/1352 | 10 Vincent Aspey Pl,Section | LOT 136 DPS 27367 | 0.1042 | 4/5 | 1D | Crown - DOSLI | | CD1 |
| 1477 44A/569 | 15 Vincent Aspey Pl,Section | LOT 139 DPS 27367 | 0.0995 | 4/5 | 1D | Crown - DOSLI | | CD1 |
| 1478 25A/1376 | 7 Willoughby Pl,Section | LOT 132 DPS 27368 | 0.0668 | 4/5 | 1D | Crown - DOSLI | | CD1 |
| 1479 25A/1370 | 10 Douglas Pl,Section | LOT 104 DPS 27368 | 0.1303 | 4/5 | 1D | Crown - DOSLI | | CD1 |

APPENDIX 2

(Reference: Clause 2.2)

**Amendments to Attachment 2 and Attachment 3 relating to “Railcorp”
portfolios.**

Attachment 2: Settlement Land

Deed Of Settlement

| 1 | 2 | 3 | 4 | 5 | 6 | 7 | 8 | 9 |
|--|---------------------|-----------|----------|------------|--------------|--------------|-----|-----------|
| Property Detail | Quarter of Transfer | Tfr Basis | Agency | Lease Form | Initial term | Renewal Term | No. | Portfolio |
| 1518 | 4/1 | 2B | Railcorp | | | | | RAIL1 |
| CPI 33071, 33070, 33055, 16243 Te Kauwhata LOT1, DPS | | | | | | | | |
| 1519 | 4/1 | 2B | Railcorp | | | | | RAIL1 |
| CPI 33061 Te Kauwhata LOT4, DPS | | | | | | | | |
| 1520 | 4/1 | 2B | Railcorp | | | | | RAIL1 |
| CPI 33062 Te Kauwhata LOT3, DPS | | | | | | | | |
| 1521 | 4/1 | 2B | Railcorp | | | | | RAIL1 |
| CPI 33063 Te Kauwhata LOT2, DPS | | | | | | | | |
| 1522 | 4/1 | 2B | Railcorp | | | | | RAIL1 |
| CPI 33080 Ohinewai LOT1, DPSS61152 | | | | | | | | |
| 1523 | 4/1 | 2B | Railcorp | | | | | RAIL1 |
| CPI 30977 Huntly LOT1, DPS 61148 | | | | | | | | |
| 1524 | 4/1 | 2B | Railcorp | | | | | RAIL1 |
| CPI 30975 Huntly PT LOT1, DPS 72817 | | | | | | | | |
| 1525 | 4/1 | 2B | Railcorp | | | | | RAIL1 |
| CPI 31603, 31602, 31604 Taupiri LOT1, DPS 67561 | | | | | | | | |
| 1526 | 4/1 | 2B | Railcorp | | | | | RAIL1 |
| CPI 30824 Ngaruawahia LOT1, DPS 61068 | | | | | | | | |
| 1527 | 4/1 | 2B | Railcorp | | | | | RAIL1 |
| CPI 30823, 30822 Ngaruawahia LOT1, DPS | | | | | | | | |
| 1528 | 4/1 | 2B | Railcorp | | | | | RAIL1 |
| CPI 30821 Ngaruawahia LOT1, DPS 63360 | | | | | | | | |
| 1529 | 4/1 | 2B | Railcorp | | | | | RAIL1 |
| CPI 30820 Ngaruawahia LOT2, DPS 63964 | | | | | | | | |
| 1530 | 4/1 | 2B | Railcorp | | | | | RAIL1 |
| CPI 30818, 30819 Ngaruawahia LOT1, DPS | | | | | | | | |
| 1531 | 4/1 | 2B | Railcorp | | | | | RAIL1 |
| CPI 30817, 30816, 30815, 30814 Ngaruawahia LOT1, DPS | | | | | | | | |
| 1532 | 4/1 | 2B | Railcorp | | | | | RAIL1 |
| CPI 31624 Ngaruawahia LOT2, DPS | | | | | | | | |
| 1533 | 4/1 | 2B | Railcorp | | | | | RAIL1 |
| CPI 31626 | | | | | | | | |
| 1534 | 4/1 | 2B | Railcorp | | | | | RAIL1 |
| CPI 31627 | | | | | | | | |
| 1535 | 4/1 | 2B | Railcorp | | | | | RAIL1 |
| CPI 31630 Ngaruawahia LOT1, DPS 72361 | | | | | | | | |
| 1536 | 4/1 | 2B | Railcorp | | | | | RAIL1 |
| CPI 31631 Ngaruawahia LOT1, DPS 59959 | | | | | | | | |
| 1537 | 4/1 | 2B | Railcorp | | | | | RAIL1 |
| CPI 31635 Ngaruawahia LOT3, DPS 59959 | | | | | | | | |
| 1538 | 4/1 | 2B | Railcorp | | | | | RAIL1 |
| CPI 31634 Ngaruawahia LOT2, DPS 59959 | | | | | | | | |
| 1539 | 4/1 | 2B | Railcorp | | | | | RAIL1 |
| CPI 30788 Horotui LOT1, DPS 61260 | | | | | | | | |
| 1540 | 4/1 | 2B | Railcorp | | | | | RAIL1 |
| CPI 30789 Horotui LOT2, DPS 61260 | | | | | | | | |
| 1541 | 4/1 | 2B | Railcorp | | | | | RAIL1 |
| CPI 30790, 30793, 30791, 30792 Horotui LOT3, DPS 61260 | | | | | | | | |
| 1542 | 4/1 | 2B | Railcorp | | | | | RAIL1 |
| CPI 30166 Te Rapa LOT4, DPS 14237 | | | | | | | | |
| 1543 | 4/1 | 2B | Railcorp | | | | | RAIL1 |
| CPI 30165, 30042 Te Rapa LOT2, DPS 56691 | | | | | | | | |
| 1544 | 4/1 | 2B | Railcorp | | | | | RAIL1 |
| CPI 30041, 30040 Te Rapa LOT1, DPS 56891 | | | | | | | | |

Attachment 2: Settlement Land

Deed Of Settlement

| 1 | 2 | 3 | 4 | 5 | 6 | 7 | 8 | 9 |
|-----------------|---------------------|-----------|--------|------------|--------------|--------------|-----|-----------|
| Property Detail | Quarter of Transfer | Tfr Basis | Agency | Lease Form | Initial term | Renewal Term | No. | Portfolio |
| 1545 46A/129 | | | | | | | | |
| 1546 18A/452 | | | | | | | | |
| 1547 46D/280 | | | | | | | | |
| 1548 53C/378 | | | | | | | | |
| 1549 46B/104 | | | | | | | | |
| 1550 46B/105 | | | | | | | | |
| 1551 | | | | | | | | |
| 1552 52D/770 | | | | | | | | |
| 1555 39D/564 | | | | | | | | |
| 1556 39D/565 | | | | | | | | |
| 1557 39D/566 | | | | | | | | |
| 1558 39D/567 | | | | | | | | |
| 1559 39D/568 | | | | | | | | |
| 1560 2011/15 | | | | | | | | |
| 1561 53A/511 | | | | | | | | |
| 1562 29C/164 | | | | | | | | |
| 1563 44D/554 | | | | | | | | |
| 1564 10B/1045 | | | | | | | | |
| 1565 22B/22 | | | | | | | | |
| 1566 1496/65 | | | | | | | | |
| 1567 40D/438 | | | | | | | | |
| 1568 53A/882 | | | | | | | | |
| 1569 50A/782 | | | | | | | | |
| 1570 21B/1053 | | | | | | | | |

Attachment 2: Settlement Land

Deed Of Settlement

| 1 | 2 | 3 | 4 | 5 | 6 | 7 | 8 | 9 |
|---|---------------------|------------|----------|------------|--------------|--------------|-----|-----------|
| Property Detail | Quarter of Transfer | Trfr Basis | Agency | Lease Form | Initial term | Renewal Term | No. | Portfolio |
| 1571 721/32 | | | | | | | | |
| CPI PT 30176 | 4/1 | 2B | Railcorp | | | | | RAIL1 |
| 1572 721/31 | | | | | | | | |
| CPI PT 30176 | 4/1 | 2B | Railcorp | | | | | RAIL1 |
| 1573 43C/249 | | | | | | | | |
| CPI 30175 | 4/1 | 2B | Railcorp | | | | | RAIL1 |
| 1574 58B/552, 373/225, 480/137, 241, 242, 481/22 | | | | | | | | |
| CPI 34449 | 4/1 | 2B | Railcorp | | | | | RAIL1 |
| 1575 53D/259 | | | | | | | | |
| CPI 34744 | 4/1 | 2B | Railcorp | | | | | RAIL1 |
| 1576 | | | | | | | | |
| CPI 30002 | 4/1 | 2B | Railcorp | | | | | RAIL1 |
| 1577 | | | | | | | | |
| CPI 34476 | 4/1 | 2B | Railcorp | | | | | RAIL1 |
| 1578 46B/519 | | | | | | | | |
| CPI 30079 | 4/1 | 2B | Railcorp | | | | | RAIL1 |
| 1579 46B/520 | | | | | | | | |
| CPI 30080 | 4/1 | 2B | Railcorp | | | | | RAIL1 |
| 1580 46B/521 | | | | | | | | |
| CPI 30081 | 4/1 | 2B | Railcorp | | | | | RAIL1 |
| 1581 46B/522 | | | | | | | | |
| CPI 30082 | 4/1 | 2B | Railcorp | | | | | RAIL1 |
| 1582 12B/881 | | | | | | | | |
| CPI 30084 | 4/1 | 2B | Railcorp | | | | | RAIL1 |
| 1584 23A/1370 | | | | | | | | |
| CPI 30105 | 4/1 | 2B | Railcorp | | | | | RAIL1 |
| 1585 46C/759 | | | | | | | | |
| CPI 34200, 30106 | 4/1 | 2B | Railcorp | | | | | RAIL1 |
| 1586 12B/880 | | | | | | | | |
| CPI 30083 | 4/1 | 2B | Railcorp | | | | | RAIL1 |
| 1587 12B/1252 | | | | | | | | |
| CPI 30099 | 4/1 | 2B | Railcorp | | | | | RAIL1 |
| 1588 7C/377 | | | | | | | | |
| CPI 30102 | 4/1 | 2B | Railcorp | | | | | RAIL1 |
| 1589 7C/376 | | | | | | | | |
| CPI 30101 | 4/1 | 2B | Railcorp | | | | | RAIL1 |
| 1590 7C/375 | | | | | | | | |
| CPI 30100 | 4/1 | 2B | Railcorp | | | | | RAIL1 |
| 1591 28A/1003 | | | | | | | | |
| CPI 30070 | 4/1 | 2B | Railcorp | | | | | RAIL1 |
| 1592 47C/505 | | | | | | | | |
| CPI 30071 | 4/1 | 2B | Railcorp | | | | | RAIL1 |
| 1593 | | | | | | | | |
| CPI 30172, PT 30073 | 4/1 | 2B | Railcorp | | | | | RAIL1 |
| 1594 | | | | | | | | |
| CPI PT 30073 | 4/1 | 2B | Railcorp | | | | | RAIL1 |
| 1595 5A/1178 | | | | | | | | |
| CPI 30065 | 4/1 | 2B | Railcorp | | | | | RAIL1 |
| 1596 5A/1176 | | | | | | | | |
| CPI 30066 | 4/1 | 2B | Railcorp | | | | | RAIL1 |

Attachment 2: Settlement Land

Deed Of Settlement

| 1 | 2 | 3 | 4 | 5 | 6 | 7 | 8 | 9 |
|--|---------------------|-----------|----------|------------|--------------|--------------|-----|-----------|
| Property Detail | Quarter of Transfer | Tfr Basis | Agency | Lease Form | Initial term | Renewal Term | No. | Portfolio |
| 1597 52D/740 | | | | | | | | |
| CPI 30057, 30058, 34732, 34733 | 4/1 | 2B | Railcorp | | | | | RAIL1 |
| Claudlands LOTS 1 AND 2, DPS 63028 | | | | | | | | |
| 0.3657 | 4/1 | 2B | Railcorp | | | | | RAIL1 |
| Claudlands Lot 1, DPS | | | | | | | | |
| 1598 | | | | | | | | |
| CPI 34734, 34738, 34735, 34739, 34736, 34740, 34737 | 4/1 | 2B | Railcorp | | | | | RAIL1 |
| Claudlands | | | | | | | | |
| 1599 47A/266 | | | | | | | | |
| CPI 30169 | 4/1 | 2B | Railcorp | | | | | RAIL1 |
| Claudlands LOT1, DPS 57386 | | | | | | | | |
| 0.4581 | 4/1 | 2B | Railcorp | | | | | RAIL1 |
| CPI 31960 | 4/1 | 2B | Railcorp | | | | | RAIL1 |
| Matangi LOT1, DPS | | | | | | | | |
| 1601 49D/524 | | | | | | | | |
| CPI 31961 | 4/1 | 2B | Railcorp | | | | | RAIL1 |
| Matangi LOT1, DPS 61203 | | | | | | | | |
| 0.4043 | 4/1 | 2B | Railcorp | | | | | RAIL1 |
| CPI 31962 | 4/1 | 2B | Railcorp | | | | | RAIL1 |
| Matangi LOT2, DPS 1409 | | | | | | | | |
| 1602 | | | | | | | | |
| CPI 31772 | 4/1 | 2B | Railcorp | | | | | RAIL1 |
| Rukuhua LOT1, DPS 70064 | | | | | | | | |
| PRE-ALLOCATED | | | | | | | | |
| 1603 56B/14 | | | | | | | | |
| CPI 31772 | 4/1 | 2B | Railcorp | | | | | RAIL1 |
| Rukuhua LOT1, DPS 70064 | | | | | | | | |
| PRE-ALLOCATED | | | | | | | | |
| 1604 54B/811 | | | | | | | | |
| CPI 32007 | 4/1 | 2B | Railcorp | | | | | RAIL1 |
| Cambridge LOT1, DPS 67777 | | | | | | | | |
| PRE-ALLOCATED | | | | | | | | |
| 1605 54C/960 | | | | | | | | |
| CPI 31716, 31715 | 4/1 | 2B | Railcorp | | | | | RAIL1 |
| Ohaupo LOT1, DPS 68148 | | | | | | | | |
| 0.5442 | 4/1 | 2B | Railcorp | | | | | RAIL1 |
| CPI 30427 | 4/1 | 2B | Railcorp | | | | | RAIL1 |
| Te Awamutu LOT1, DPS 12274 | | | | | | | | |
| 0.8106 | 4/1 | 2B | Railcorp | | | | | RAIL1 |
| CPI 30422 | 4/1 | 2B | Railcorp | | | | | RAIL1 |
| Te Awamutu LOT1, DPS 61201 | | | | | | | | |
| 0.2665 | 4/1 | 2B | Railcorp | | | | | RAIL1 |
| CPI 30423 | 4/1 | 2B | Railcorp | | | | | RAIL1 |
| Te Awamutu LOT3, DPS 66881 | | | | | | | | |
| 0.279 | 4/1 | 2B | Railcorp | | | | | RAIL1 |
| CPI 30424 | 4/1 | 2B | Railcorp | | | | | RAIL1 |
| Te Awamutu LOT4, DPS 66881 | | | | | | | | |
| 4.344 | 4/1 | 2B | Railcorp | | | | | RAIL1 |
| CPI 34481, 34480, 30447, 34484, 30439, 34483, 30442, 30440, 30426, 34499, 30444, 30443, 30438, 34472 | 4/1 | 2B | Railcorp | | | | | RAIL1 |
| Te Awamutu LOT1, DPS 68576 | | | | | | | | |

Attachment 3: Improved Land

Deed Of Settlement

| 1 | 2 | 3 | 4 | 5 | 6 | 7 | 8 | 9 |
|--|---------------------|------------|--------|------------|--------------|--------------|-----|-----------|
| Property Detail | Quarter of Transfer | Trfr Basis | Agency | Lease Form | Initial term | Renewal Term | No. | Portfolio |
| 1553 56B/435 | | | | | | | | |
| CPI 34571, 30383, 34580, 30392, 30390, 30391, 34557, 34742, 30184, 34576, 34741, 34581, 30389, 34577 | | | | | | | | |
| Hamilton | | | | | | | | |
| LOT2, DPS 70366 | 4.561 | 4/1 | 1A | Railcorp | | | | RAIL1 |
| 1554 39D/529 | | | | | | | | |
| CPI 30185 | | | | | | | | |
| Hamilton | | | | | | | | |
| LOT1, DPS 37470 | 0.0745 | 4/1 | 1A | Railcorp | | | | RAIL1 |
| 1583 54C/199 | | | | | | | | |
| CPI 30090, 30093, 34290, 34595 | | | | | | | | |
| Hamilton | | | | | | | | |
| LOT2, DP 67949 & PT LOT2, DPS 63198 | 0.5561 | 4/1 | 1A | Railcorp | | | | RAIL1 |